

Picture 3
Wiring Diagram (Top View)

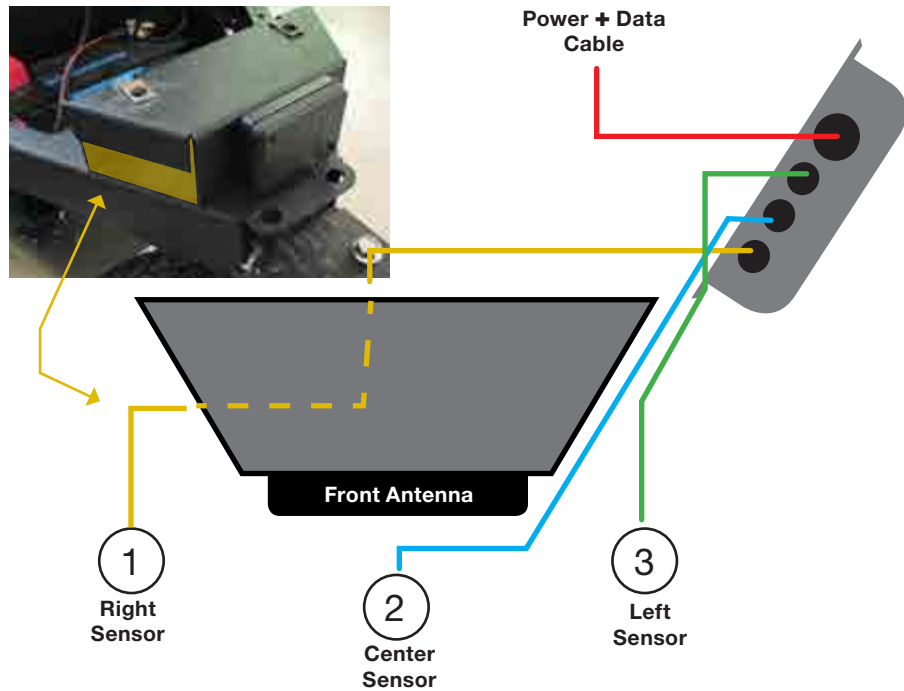

Picture 3A



Tempo[®]

WALK

Ultrasonic Sensor Installation and Replacement Instructions



www.clubcar.com

P.O. Box 204658, Augusta, Georgia 30917-4658 USA

Telephone 706-863-3000 Service Parts Fax 706-855-7413

Copyright © 2018, Club Car, LLC Club Car, Tempo Walk is a registered trademark of Club Car, LLC.

There is a Library of informational videos at
www.clubcar.com/tempowalkresources

Front Antenna

**Sensor Box
Location**



Sensor Box



Sensor Placement

(Front View Tempo Walk
Plastic Top)



**Back view of
Ultrasonic Sensor**



Ultrasonic Sensor Replacement Tips

- 1). Unscrew the middle of each broken sensor cable first.
- 2). Remove the sensors from the Tempo Walk plastic top by pushing them out from behind. (See pic 1)
- 3). Replace sensors, and make sure to orient correctly.
Note: Handle sensors gently, insert by using outside edge, avoid pressing the center of sensor.
- 4). Route cables to stay above the front caster wheel. (See pic 2)
- 5). Screw in firmly each sensor connector to its corresponding cable. (See pic 3A)
- 6). Test sensors when Tempo Walk is powered on to make sure they are operating correctly

HOW TO RESET “DISABLED” SENSORS OR SYSTEM

Once the necessary repairs have been made, follow these steps.

Step 1: Turn on the Tempo Walk, and wait for the start-up chime

Step 2: Wait for the audio about the disabled sensors
(approx. 5 secs)

Step 3: Press the neutral button “N” twice
(Located on the dashboard)

Picture 1

Ultra Sonic Sensor Box

Tempo Walk Cover

Press Clips(●) in
to move forward.

Top of sensor is positioned at
the 12 o'clock position and the
cable at the 6 o'clock position

